

This is Our Miracle Moment

Our Miracle Moment

What we thought was going to take three years or more is available to us right now. God has stepped in and accelerated our timeline. It is His desire to use us in a greater way, right now. Our offer has been accepted and our closing date is quickly approaching. The opportunity to deepen our roots to produce unstoppable fruit is now. Let's not just see this opportunity; let's seize it for God's glory. Let's yield our lives to God and believe Him to finish this supernatural planting of the Lord.



God Factors

○ **Miraculous open door**

What we thought may take years has supernaturally opened to us now. We would have never anticipated an established church selling their building. The timing of how God orchestrated all the small details starting years ago is truly a miracle.

○ **Perfect size and cost**

This building represents everything we've been looking for. The floor plan has a striking resemblance to the one we put on our brochures one year ago. The only major difference is this building is in a two floor format and is slightly bigger.

○ **Exceptional timing**

A grand opening in the fall of 2021 couldn't be more perfect. This will allow time for COVID-19 to fade into the background and for us to maximize the momentum that a new facility will bring. We have always dreamed of maximizing this momentum for God's glory.

○ **Move-in-ready building**

We won't have to renovate a thing to move in. This facility is in incredible shape. The inside was just re-carpeted, re-painted, and updated. Best of all, it is so similar to the Thrive style with a high level of excellence throughout. We requested their auditorium chairs, as well as their audio, video, and lighting equipment to be included in the sale of this building and they agreed. This will be the best equipment of any facility we have met in as a church.

○ **Two miracles for two churches**

Just as much as God has been putting it on our heart to get rooted, He has been putting it on the heart of Jubilee to take a step toward where He is calling them. This one transaction is setting off a miracle for two churches. What an incredible kingdom moment as two churches are working together to further God's work.

○ **Unanimous yes**

The Thrive Church board, Strategic Team, and our Overseers are all in 100% unity that this is the direction of the Lord for us. There wasn't even one dissenting vote. The leadership of Jubilee, as well as their board, believes this is of the Lord. Hannah and I have had numerous words from God and we carry peace and excitement about this building.



GROWTH POTENTIAL

1,000

Amount of people we could fit with two experiences (adults and kids).

2,000

Amount of people we could fit with four experiences. This would be four times the size of our current church.

BUILDING DETAILS

\$4.2m

Building cost

500

Seating capacity

19,900

Square footage

700

Total occupancy

What will it take to purchase?

01. \$650k by February 28

Raise the remaining \$650k dollars needed to bring to close by February 28th. The closing is scheduled for April, but we need to give notification that we are ready to close around 30 days out. A stretch dream goal would be \$800k which would include an additional \$150k for move-in expenses (i.e. furnish kids ministry rooms, foyer, signage, and remaining production equipment needs).

02. \$2.2m total dollars raised at the conclusion of Rooted

This is the exact amount that was pledged towards the Rooted initiative. This amount is important for us to raise because within this amount we will have the down payment needed, increase operational reserves that WIF requires, expenses to furnish the building, and retire a short-term loan of \$800k at the conclusion of Rooted in April 2023.

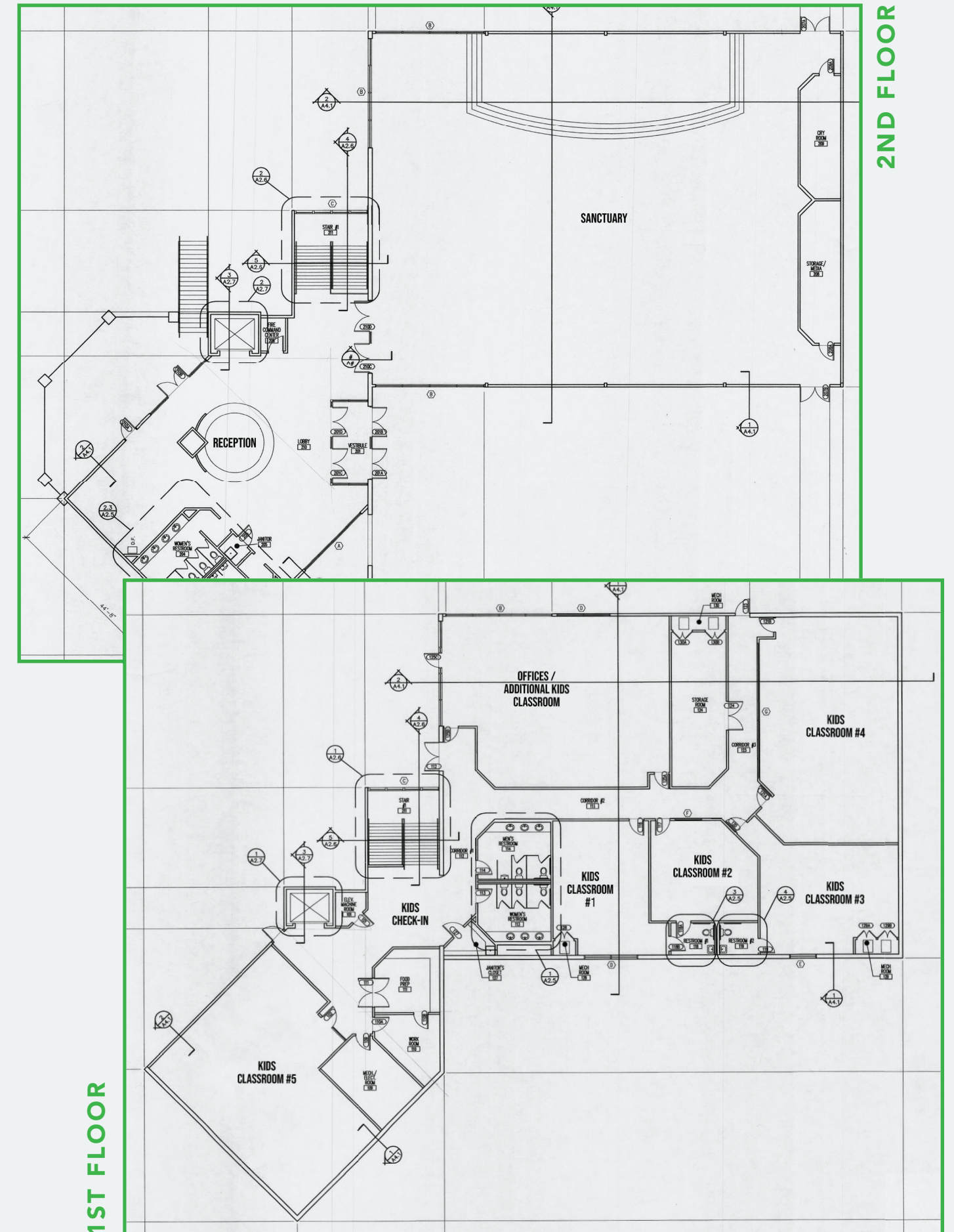



A Loan Structure We Can Afford

Our loan package is favorable and encouraging. WIF not only believes in us as a church, but they also fully recognize that we have two years left of our capital initiative beyond the purchasing of our building. They also said they really like this building.

Our short-term loan will be \$800k. This needs to be paid by our ongoing Rooted funds that will continue to come in over the next two years. We are to have a balance of \$400k in April of 2022 and \$0 in April of 2023.

Our long-term loan will be \$2.4m and cost \$12,885 per month. Our costs associated with portable church over the past two years was an average of \$12,900-\$13,600 (when we were meeting in-person). This long-term loan is an extremely manageable mortgage payment based on all the costs previously associated with portability.

This is the bottom line: It is important that we have the initial surge of money to close on the building. It is also important for us to fulfill our Rooted commitments to pay off the short-term loan.

A Regional Location

We feel that God has placed us in a regional location for His strategic purpose. All of South Denver is used to coming to Lone Tree. This is the location of the Park Meadows Mall, some of Denver's best restaurants, and the intersection of E-470 and I-25. This is a place where people can reach within a reasonable driving distance. We believe God has opened this door. Over eight years ago, I quietly said I wanted us to be as close to that intersection as possible because of its regional reach. God is enlarging us. He is extending our borders, *"Enlarge the place of your tent, And let them stretch out the curtains of your dwellings; Do not spare; Lengthen your cords, And strengthen your stakes. For you shall expand to the right and to the left, And your descendants will inherit the nations, And make the desolate cities inhabited."* Isaiah 54:2-3

Outcomes of Being Rooted

- **We will go after those who are still missing**

A permanent facility will allow us to reach up to four times more people who are far from God than we do now. We will be able to bring the gospel to up to 2,000 people per weekend and could add more with more experience times.

- **We will offer a state-of-the-art student ministry**

Our new main auditorium will also be used by our student ministry. The teenagers won't get the leftovers; they will get our best. This will position them to reach the maximum amount of teens. We want to shake South Denver with hundreds of students attending each week and hundreds making decisions to follow Christ every year.

- **We will create an excellent kids ministry space**

A building will allow us to customize each space to make the Bible come alive for our kids in an even greater way. A new space will create an even greater desire for our kids to want to come to church, which will result in deeper roots in God and a solid, unshakeable faith that will lead them throughout their lifetime.

- **We will build a home for our ministries**

Thrive Kids, Thrive Students, Courageous Men, Thrive Groups, and so many more ministries will have a place to grow and expand. The women's ministry, Flourish, will be an even greater source of joy to the city, resulting in thousands of women finding God. Our mission will not be restricted by those we rent from.

- **We will honor Jesus' mandate to bear much fruit**

Individually and as a church, it's our heart to care most about what Jesus cares most about, and that's people. Bearing much fruit is obedience to go after God's most prized possession. A permanent location is a stake in the ground for generational impact. The money given will truly be a spiritual legacy where thousands will come to know Jesus.



When will we move in?

Short answer: fall of 2021

The timing couldn't be more perfect. We are scheduled to close in April, and then allow a five month leaseback period for Jubilee. This is incredible for two reasons.

1. It is a win for Thrive because it will allow more time for the uncertainty of the global pandemic to subside and for us to launch in our new building when we can gather and celebrate in large numbers as a church. Our grand opening will not only be a time of celebration, it will be a time of increase in numbers and salvations for our church family. It is a very important spiritually strategic moment for us as a church and the timing is critical.

2. It is a win for Jubilee because it gives them time to renovate the building they will be moving into. This is two miracles for two churches! The kingdom is advancing.



“

They are like trees planted along a riverbank, with roots that reach deep into the water. Such trees are not bothered by the heat or worried by long months of drought. Their leaves stay green, and they never stop producing fruit.”

-Jeremiah 17:8

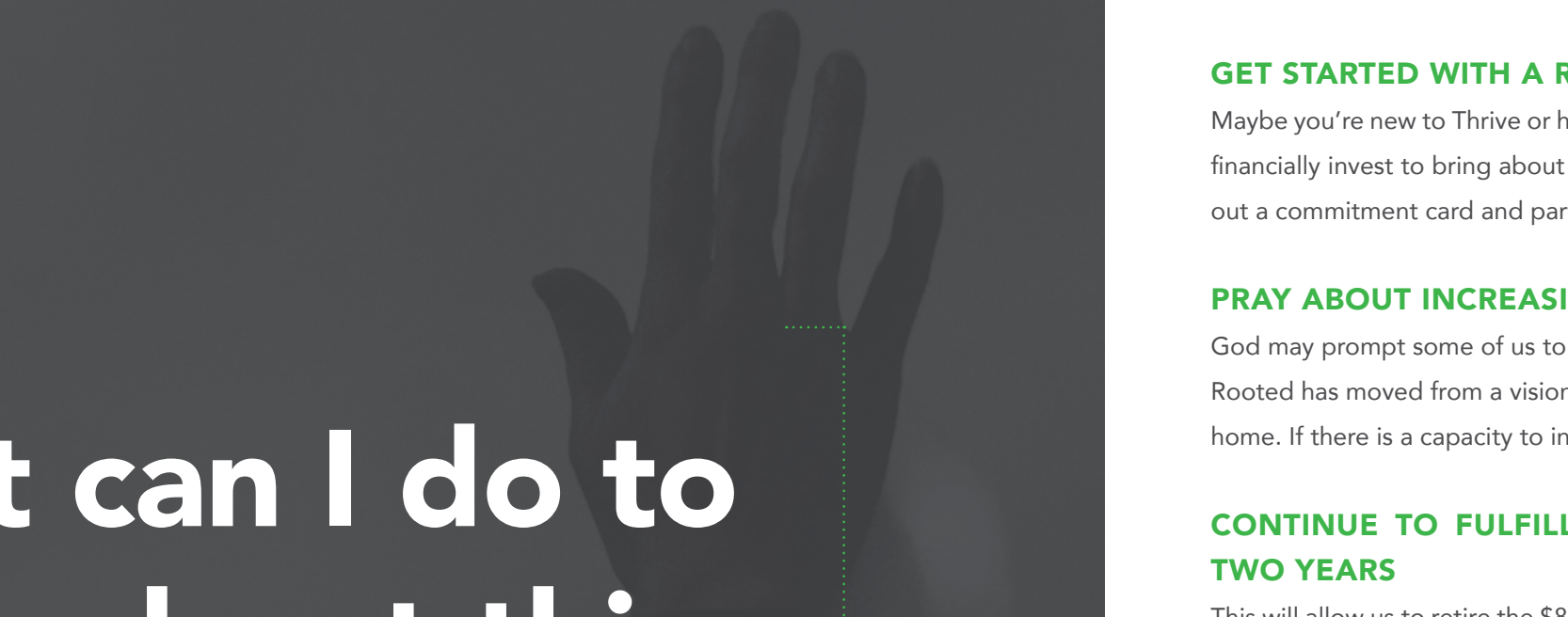

What can I do to bring about this miracle?

EXPEDITE YOUR ROOTED COMMITMENT

You may be able to give a large portion or possibly complete your Rooted commitment on or before February 28th, which will be our Rooted Miracle Sunday. We are asking you to bring the biggest surge that God would lead you to bring to close on this facility, because of this miracle opportunity.

GET STARTED WITH A ROOTED PLEDGE

Maybe you're new to Thrive or haven't made a pledge towards Rooted. Now is a significant moment to financially invest to bring about generational impact. Begin your journey in this miracle story by filling out a commitment card and participating in the miracle offering on Rooted Miracle Sunday.

PRAY ABOUT INCREASING YOUR ROOTED COMMITMENT

God may prompt some of us to increase what was originally pledged to take hold of this opportunity. Rooted has moved from a vision from the Lord, to a tangible building He has opened up as our future home. If there is a capacity to increase we are asking you to consider investing in this spiritual legacy.

CONTINUE TO FULFILL YOUR ROOTED COMMITMENT OVER THE NEXT TWO YEARS

This will allow us to retire the \$800k short-term loan that was given to us because of the remaining two years of our initiative. As we are faithful to complete our pledges above our tithes and offerings it will position us with low building expenses and a high focus on ministry expansion. This is the complete dream situation for our church.

CONSIDER ASSET-BASED GIVING

To accomplish the third miracle you may be led by the Lord to give assets. By donating long-term, appreciated assets such as stocks, real estate, and business interests before the sale, you can reduce taxes and give more to Thrive. You can give these assets through our Giving Fund with National Christian Foundation. Simply choose Thrive Church as the recipient and receive an income tax deduction at the time of the donation. For more information, call the church office at 720-295-3730.

CELEBRATE ROOTED MIRACLE SUNDAY WITH US

We will be meeting in-person as a church on February 28th for our Rooted Miracle Sunday. This will be our one year anniversary from the kickoff of Rooted where we will worship, celebrate, and bring our best financial gift. We are asking you to ask God how He would lead you to play a part in our \$650k requirement to close.

Please note: If you plan to give in March, after our Rooted Miracle Sunday, (i.e. if your corporate bonus pays out then) then we can count that toward the down payment required. Just let us know. We believe that if we all do what God prompts us to do, we will see the third miracle and a supernatural planting of God.



THRIVECHURCH.COM